

the floorplan...

GROUND FLOOR
418 sq.ft. (38.8 sq.m.) approx.

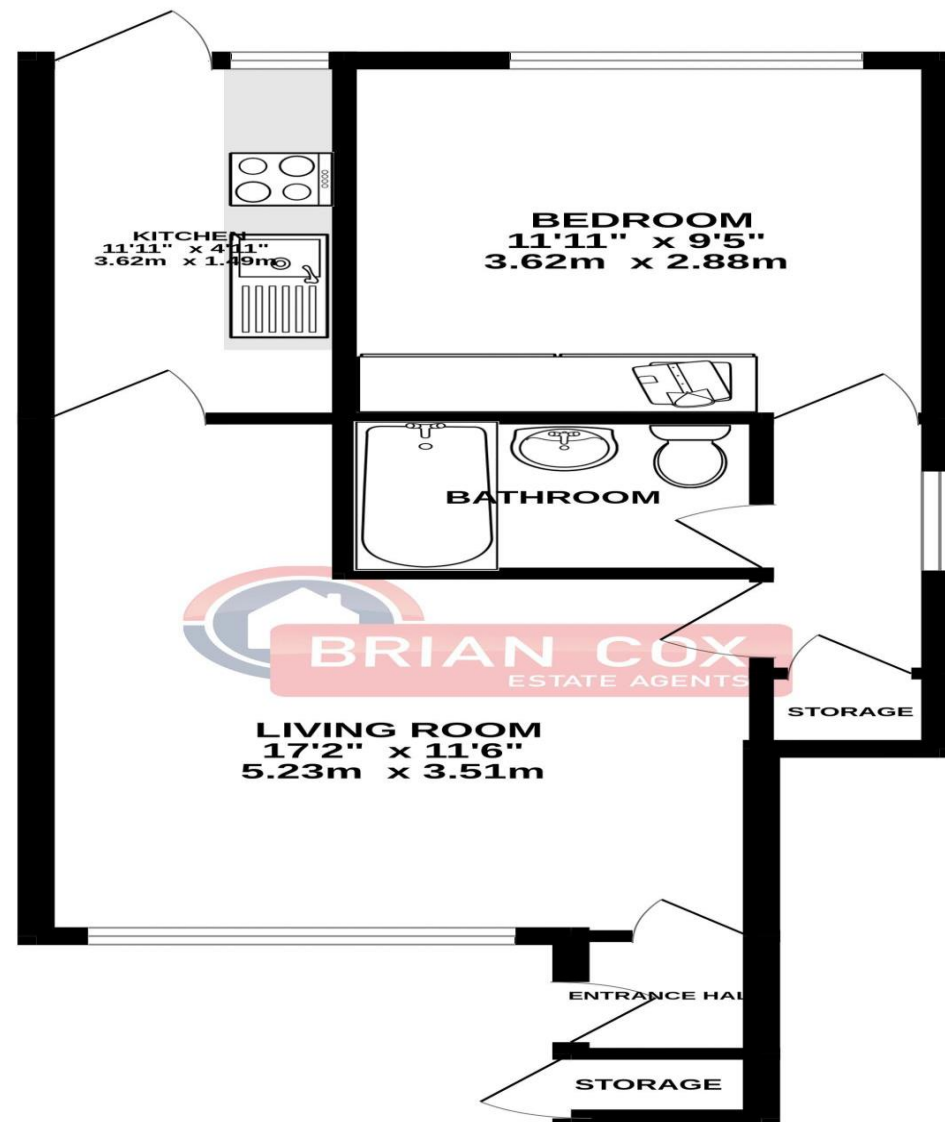

TOTAL FLOOR AREA : 418 sq.ft. (38.8 sq.m.) approx.

Whilst every attempt has been made to ensure the accuracy of the floorplan contained here, measurements of doors, windows, rooms and any other items are approximate and no responsibility is taken for any error, omission or mis-statement. This plan is for illustrative purposes only and should be used as such by any prospective purchaser. The services, systems and appliances shown have not been tested and no guarantee as to their operability or efficiency can be given.
Made with Metropix ©2025

more details from...

call: **Brian Cox Greenford: 0208 578 1004**

email: emma.gerald@brian-cox.co.uk

web: www.brian-cox.co.uk



0208 578 1004
brian-cox.co.uk



Brian Cox and Company are proud to present to the market this purpose built one bedroom ground floor maisonette. The property boasts a lease in excess of 900 years. Comprising a fitted kitchen, a good sized lounge, family bathroom and a double bedroom this home is not to be missed. Further benefits include private rear garden, double glazing, gas central heating, and an allocated parking space. Viewings are highly recommended to fully appreciate all on offer, so call now to arrange yours!!



£275,000
Leasehold

Dacre Close, Greenford, UB6 9UQ

Consumer Protection from Unfair Trading Regulations 2008 We have not tested any apparatus, equipment, fixtures, fittings or services and so cannot verify that they are in working order or fit for purpose. You are advised to obtain verification from your solicitor or surveyor. References to the tenure of a property are based on information supplied by the seller. We have not had sight of the title documents and a buyer is advised to obtain verification from their solicitor. Items shown in photographs are not included unless specifically mentioned within the sales particulars, but may be available by separate negotiation. We advise you to book an appointment to view before embarking on any journey to see a property, and check its availability.



in brief...

- One Bedroom
- Ground Floor Maisonette
- Private Rear Garden
- Approx. 953 Year Lease
- Allocated Parking Space
- No Ground Rent



the location...

nearest stations ...

Greenford (0.6 miles)
Northolt (0.9 miles)
South Greenford (0.9 miles)

Greenford is a large suburb in the London Borough of Ealing in West London, UK. It was an ancient parish in the historic county of Middlesex. It is 11 miles (18 km) from Charing Cross in Central London.

There are several local primary schools in the area which include Coston Primary School, Edward Betham Church of England Primary School, Ravenor Primary School and Oldfield Primary School.

If you have older children there are also local secondary schools nearby these include William Perkin Church of England High School, Greenford High School and The Cardinal Wiseman Catholic School.

0208 578 1004

brian-cox.co.uk